

WATERSILO CISTERN
DRILLED SHAFT TECHNOLOGY
 STORAGE: 2500-30,000+ GAL
 FOOTPRINT: 12' DIAM., 110 SF

FRAME & COVER OVER CONCRETE RISER
 24" DIAM., CAST IRON

RISER & LID
 6" TALL, PLASTIC

PUMP CONDUITS
 1" ELECTRICAL, 2" DISCHARGE

RC SLAB
 8" THICK, H-20 RATED

INFLOW PIPE
 4" PVC (or as required)

FRP TANK
 11'-2" ID

CONCRETE ENCASEMENT
 4" THICK, 4,000 PSI

BASE CONCRETE
 8" THICK

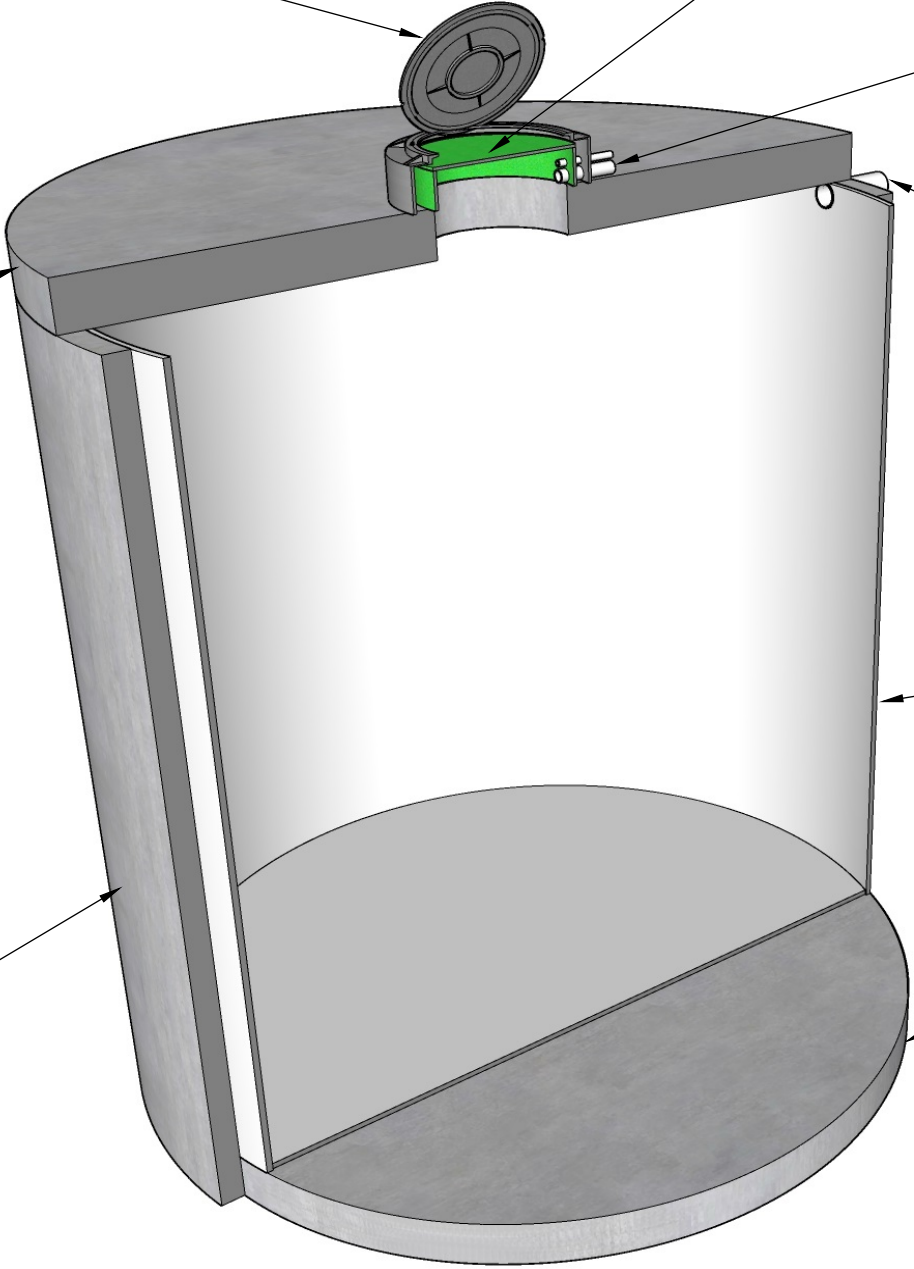

SEITec
WaterSilo

25500 HAWTHORNE BLVD, #2230
 TORRANCE, CA 90505
 www.WaterSilo.us

CONTACT INFORMATION

WATERSILO SUPPLIER: SEITEC
 CONTACT NAME: SHAHRIAR EFTEKHARZADEH
 CELL PHONE: 310-879-9376
 SALES EMAIL: INFO@SEITECINC.COM

CONFIGURATION

1.0

SPECIFICATIONS DRILLED SHAFT TECHNOLOGY

SPECIFICATIONS

WATERSILO	STORMWATER CISTERN
STRUCTURE	CONCRETE
CONTAINMENT	FRP
STORAGE DEPTH (H), FT	SEE TABLE
OUTSIDE DIAMETER (OD), IN	142.0
INSIDE DIAMETER (ID), IN	134.0
STORAGE CAPACITY, GAL	SEE TABLE
BASE CONCRETE DEPTH (D), IN	8.0
ENCASEMENT THICKNESS (T), IN	4.0
COVER	H-20 RATED RC SLAB
RC SLAB THICKNESS (A), IN	8.0
FRAME AND COVER HEIGHT (Z), IN	8.0
EXCAVATION DEPTH (Y), FT	SEE TABLE
WATERSILO ACCESS	CAST IRON FRAME & COVER
ACCESS DIA., IN	24
INFLOW PIPE	4" PVC (or as required)
PUMP CONDUITS	1" ELECTRICAL, 2" DISCHARGE PIPE

CAPACITY OPTIONS

CAPACITY, GAL	STORAGE DEPTH (H), FT	EXCAVATION DEPTH (Y), FT
2,500	3.4	4.7
5,000	6.8	8.2
7,500	10.2	11.6
10,000	13.7	15.0
15,000	20.5	21.8
20,000	27.3	28.6
25,000	34.1	35.5
30,000	41.0	42.3

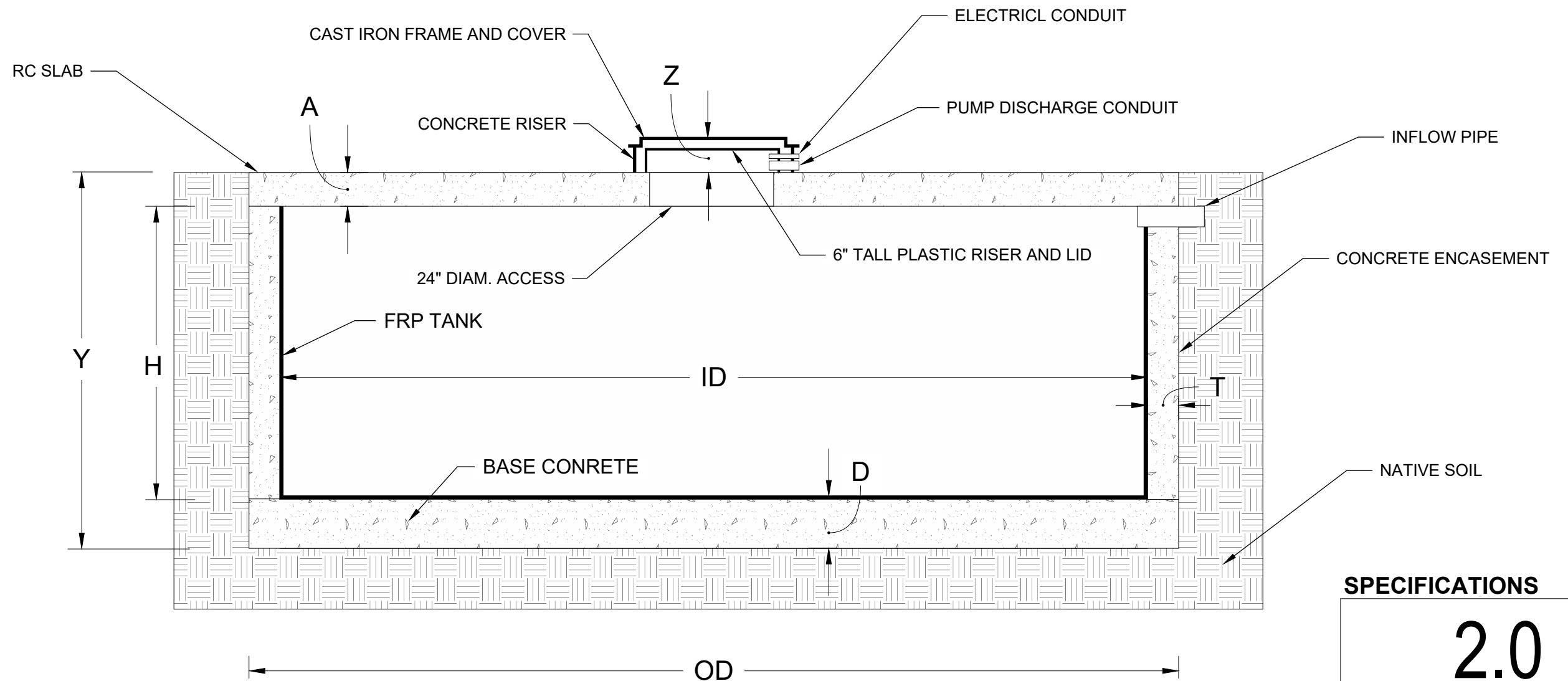

SPECIFICATIONS

2.0

SEITec
WaterSilo

25500 HAWTHORNE BLVD, #2230
TORRANCE, CA 90505
www.WaterSilo.us

INSTALLATION STEPS DRILLED SHAFT TECHNOLOGY

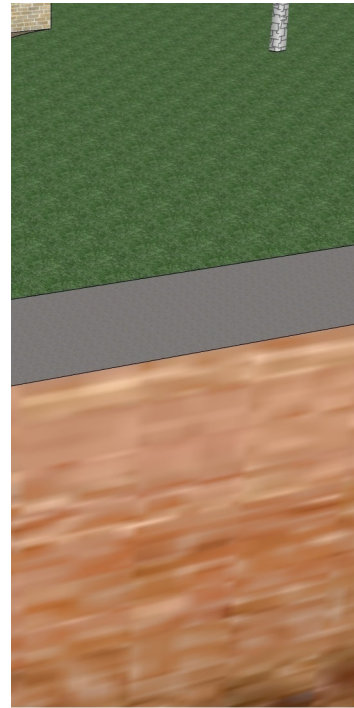

Front Lawn

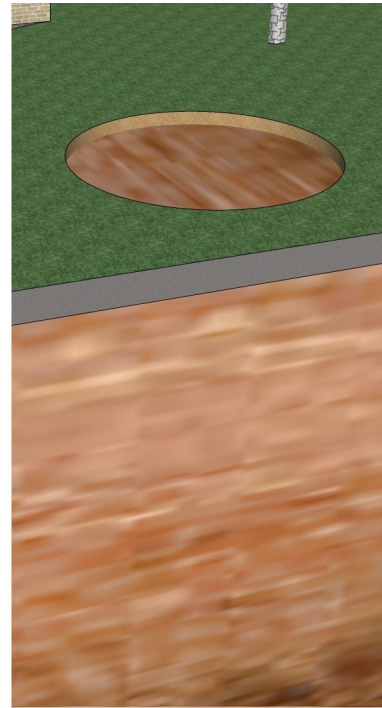

1. Excavate Footprint



2. Drill Shaft



3. Pour Base Concrete

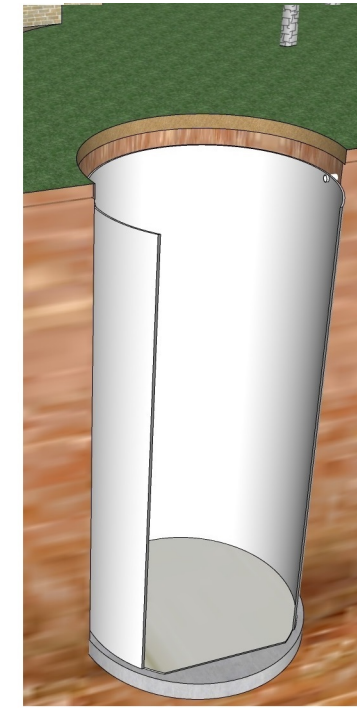

4. Insert Tank

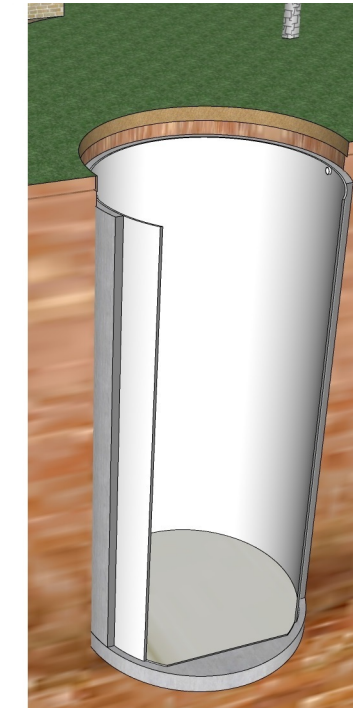

5. Pour Encasement Concrete

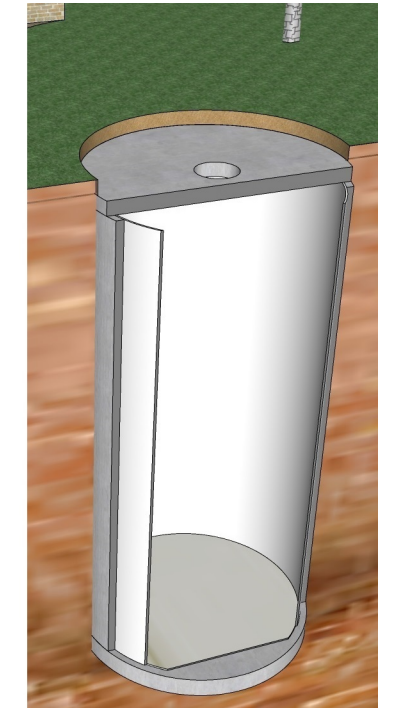

6. Place RC Slab

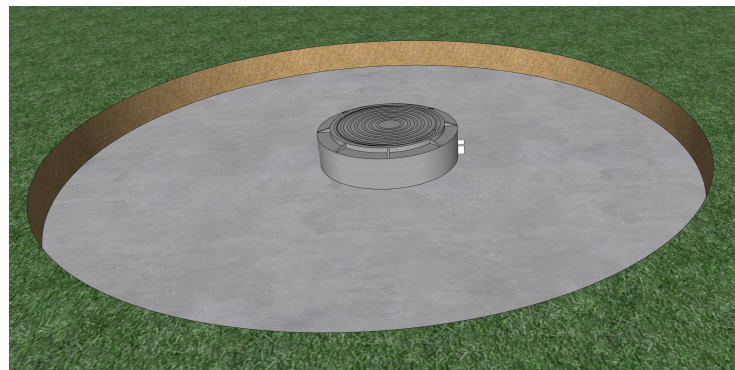

7. Install Frame and Cover

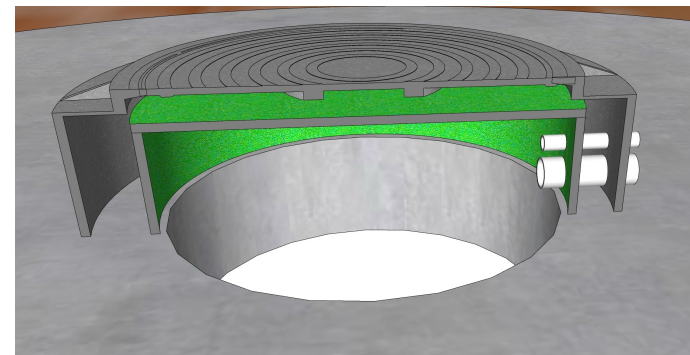

Frame and Cover Detail



Installed Cistern



8. Restore Lawn

SEITec
WaterSilo

25500 HAWTHORNE BLVD, #2230
TORRANCE, CA 90505
www.WaterSilo.us

INSTALLATION STEPS

3.0